

HYDRAULIC CYLINDER

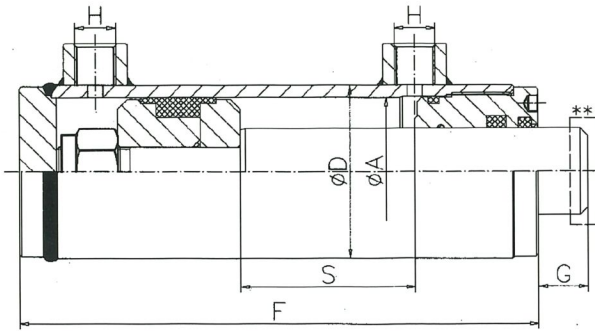

STANDARD CYLINDERS

1. Working diameter - ϕA mm.
2. Tube: - DIN 239 ISO H9
3. Rod: - steel St - 52.3 (C 45);
Chrome 25^{±5} micron
4. Temperature range: - 25°C + 80°C
5. Max peak pressure: max 200 bar

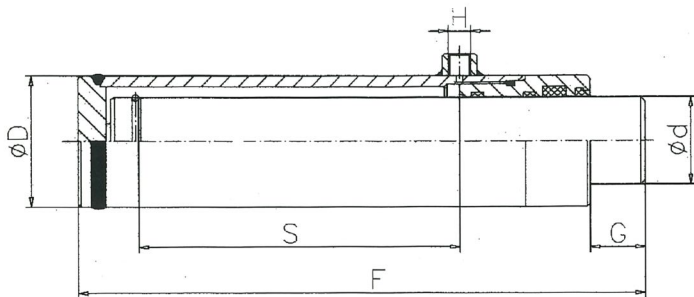

PLUNGER CYLINDER

1. Plunger: - steel St 52.3 (C45)
2. Max peak pressure: max 200 bar
3. Chrome: 25^{±5} micron
4. Temperature range: - 25°C + 80°C
5. Plunger speed: max 20m/min

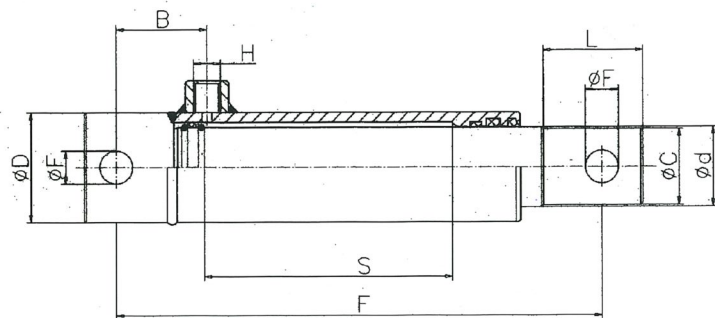

SYNGLE ACTING CYLINDER

1. Working diameter - ϕA mm.
 2. Tube: - DIN 239 ISO H9
 3. Rod: - steel St - 52.3 (C 45);
Chrome 25^{±5} micron
 4. Temperature range: - 25°C + 80°C
- Max peak pressure: max 200 Bar

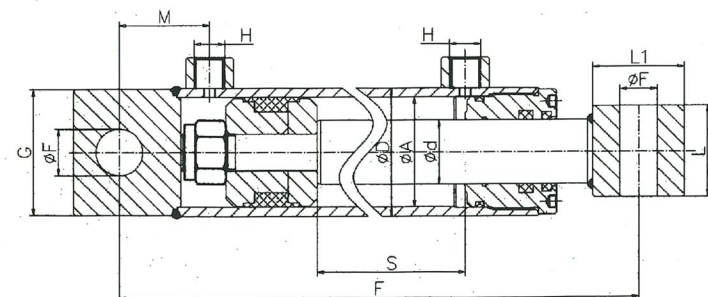

DOUBLE ACTING CYLINDER

1. Working diameter - ϕA mm.
 2. Tube: - DIN 239 ISO H9
 3. Rod: - steel St 52.3 (C 45);
Chrome 25^{±5} micron
 4. Temperature range: - 25°C + 80°C
- Max peak pressure: max 200 Bar